

- KEY**
- PROPOSED FOOTWAY/CYCLEWAY
 - VEHICLE CROSSOVER - BLACK COLOUR
 - EXISTING BLISTER PAVING FLAGS - BUFF
 - LADDER PAVING FLAGS - BUFF
 - CORDUROY PAVING FLAGS - BUFF
 - PROPOSED LANDSCAPING TOP SOIL INVERTED WITH SUB-SOIL MINIMUM 200mm AND WILD GRASS SEED MIX. SEE NOTES 1 & 2.
 - RELOCATE EXISTING STREET LIGHTING UNIT
 - CYCLE SYMBOL 1215mm HIGH TO DIAGRAM 1057
 - PEDESTRIAN SYMBOL 1215mm HIGH
 - PROPOSED BOLLARD LOCATION
- NOTES**
- 1 GRASS SEED MIX TO BE EMORGATE SEED MIX EG1 AND EC1F SOWING RATE OF 5g/m² & 1.5g/m² RESPECTIVELY.
 - 2 DAFFODIL BULBS TO BE PLANTED OUTSIDE BRIDGWATER SELF STORAGE.
 - 3 LIGHTING COLUMN RELOCATION WORKS TO BE CARRIED SCC STREET LIGHTING CONTRACTOR.

INSET A
SCALE 1:200

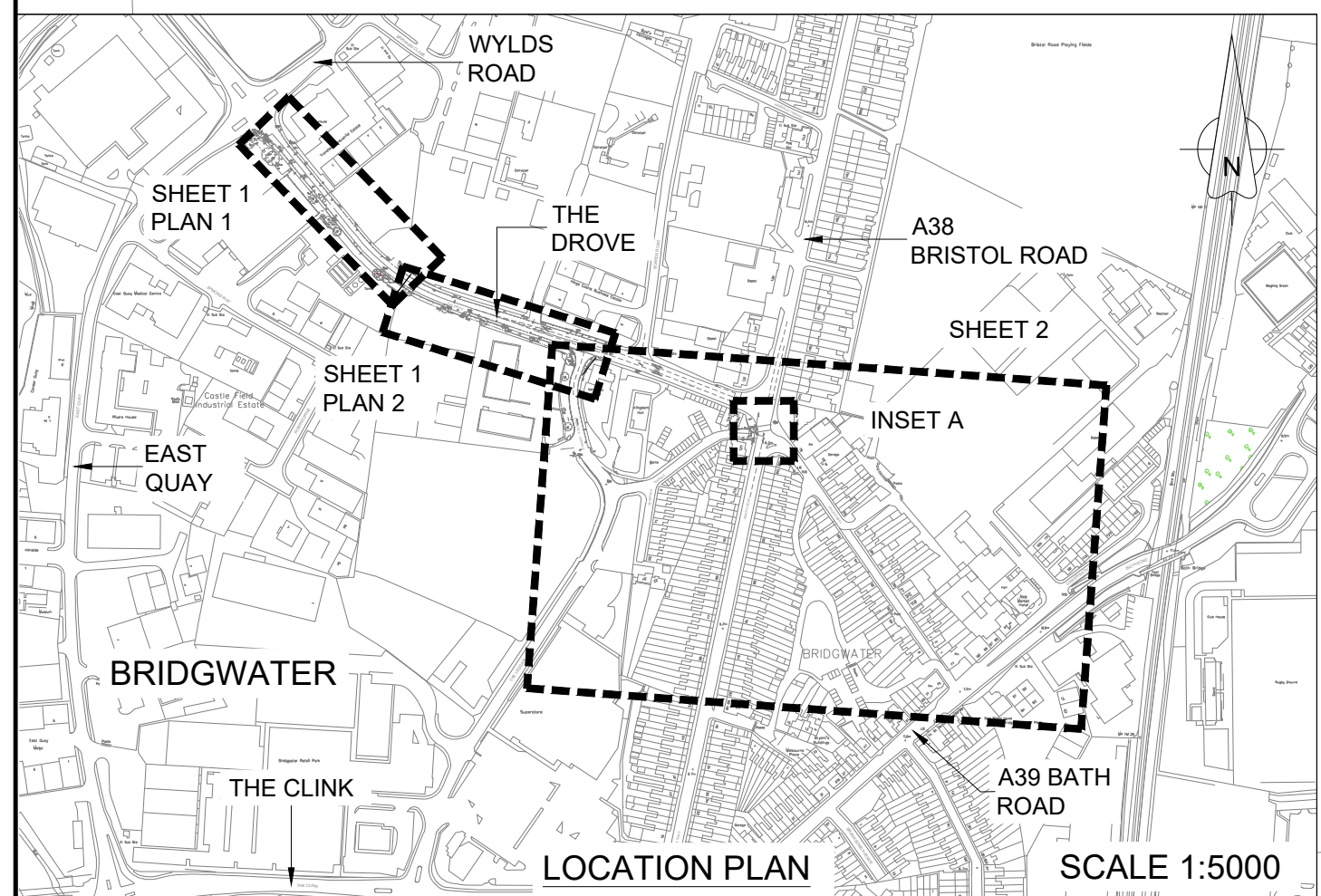
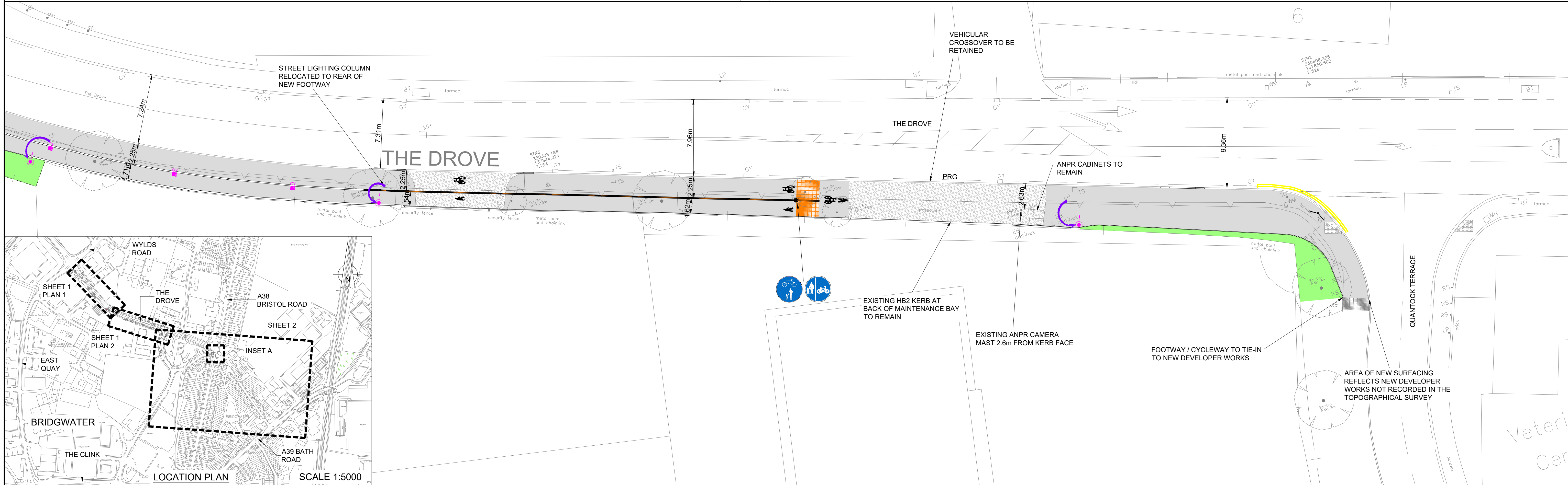

Rev	Description	By	Date	Chk'd	Auth

SOMERSET
Somerset County Council ©
 Traffic & Transport Development Group
 County Hall
 Taunton
 Somerset
 TA1 4DY
 TEL: (0300) 123 2224
 www.somerset.gov.uk

Client	SOMERSET COUNTY COUNCIL
Project	BRIDGWATER CYCLE ROUTES ELEMENT 3 WYLD'S ROAD - THE DROVE TO A39 BATH ROAD

Title	GENERAL ARRANGEMENT SHEET 1 OF 2
File Name	MN004174-HW-003-004-Rev -General Arrangement
Original Scale	AS SHOWN
Page Size	A1
Drawn	EB/EL
Checked	WS
Authorised	EST
Date	28/08/18
Date	21/12/18
Date	21/12/18
Drawing Number	MN004174-HW-003
Status	-
Rev	-

© Crown Copyright and database right (2018). Ordnance Survey 100038382
 Report: I:\ENGINEERING DESIGN TEAM\Winky - Walking-Cycling\MN004174 E1 3 - Wyls Rd-The Drive to A39 Bath Rd\A1 CAD\A1 Working Drawings