

**Appendix 20. Conveyance of Lands, 1888**



That piece or parcel of Common or Waste land numbered 69 the Map of the Common of Combe Saint Nicholas aforesaid containing [...] acres [...] roods and one perch bounded on the north east by old inclosures in the south by allotments numbered 67 and 68 in the [west?] and north west by Drove ways being part of an allotment set out [to?] Richard Cockington in [...] of his fee [simple?] [...] situate at Clay Hanger in the said Parish of Combe Saint Nicholas [...] an Act of the fifty fourth year of the reign of his late Majesty King George the Third entitled "An Act for inclosing lands in the parish of Combe Sant Nicholas in the county of Somerset" which said piece or parcel of land is numbered 632 on the Tithe Map of Combe Saint Nicholas aforesaid...

Transcript: "That piece or parcel of Common or Waste land numbered 69 the Map of the Common of Combe Saint Nicholas aforesaid containing [...] acres [...] roods and one perch bounded on the north east by old inclosures in the south by allotments numbered 67 and 68 in the [west?] and north west by Drove ways being part of an allotment set out [to?] Richard Cockington in [...] of his fee [simple?] [...] situate at Clay Hanger in the said Parish of Combe Saint Nicholas [...] an Act of the fifty fourth year of the reign of his late Majesty King George the Third entitled "An Act for inclosing lands in the parish of Combe Sant Nicholas in the county of Somerset" which said piece or parcel of land is numbered 632 on the Tithe Map of Combe Saint Nicholas aforesaid...

Together with all ways rights easements [... ..] and appurtenances to the same belonging or usually held therewith ..."

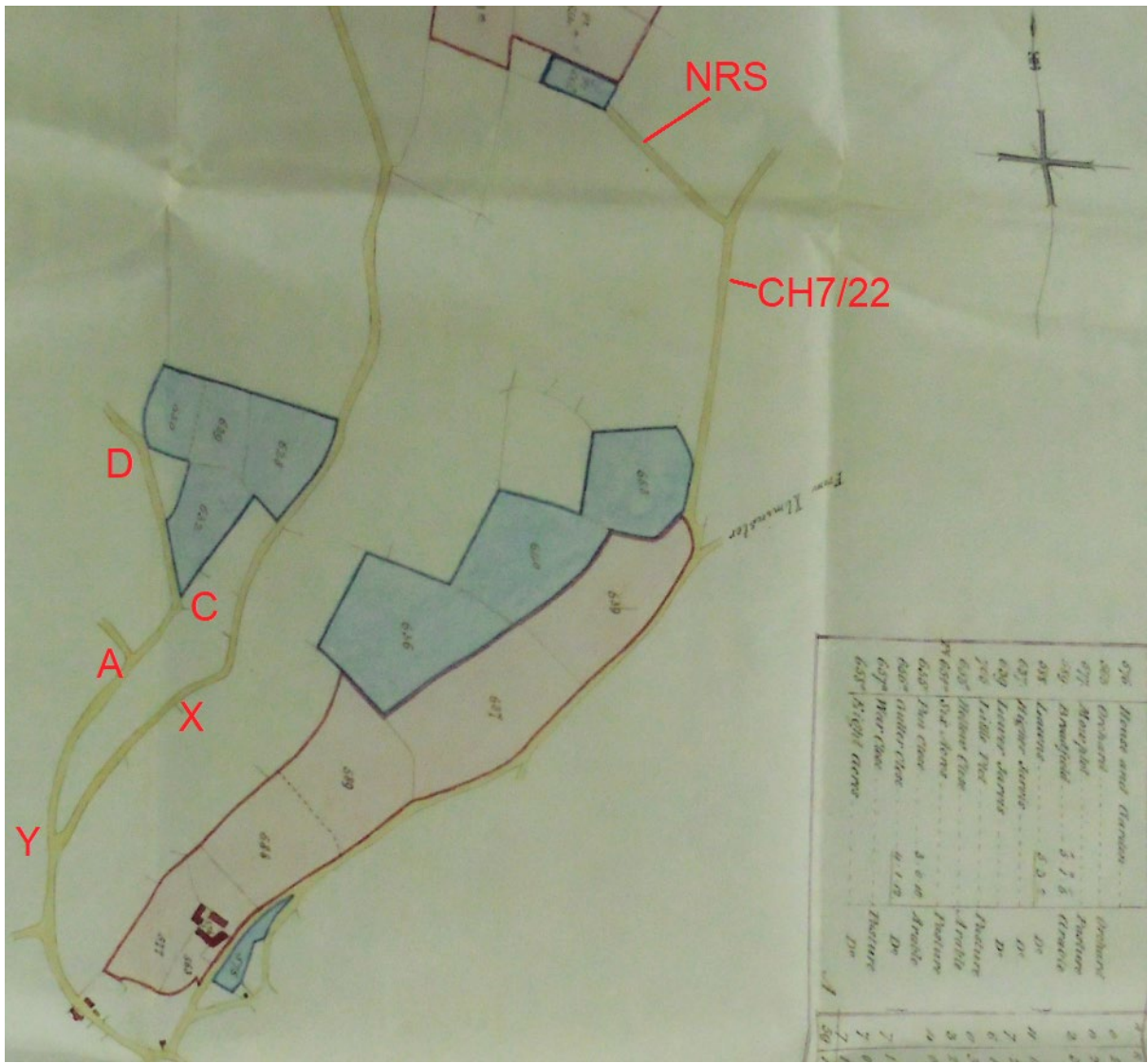

NRS = No Recorded Status