

**Appendix 21. Conveyance of Lands, 1912**

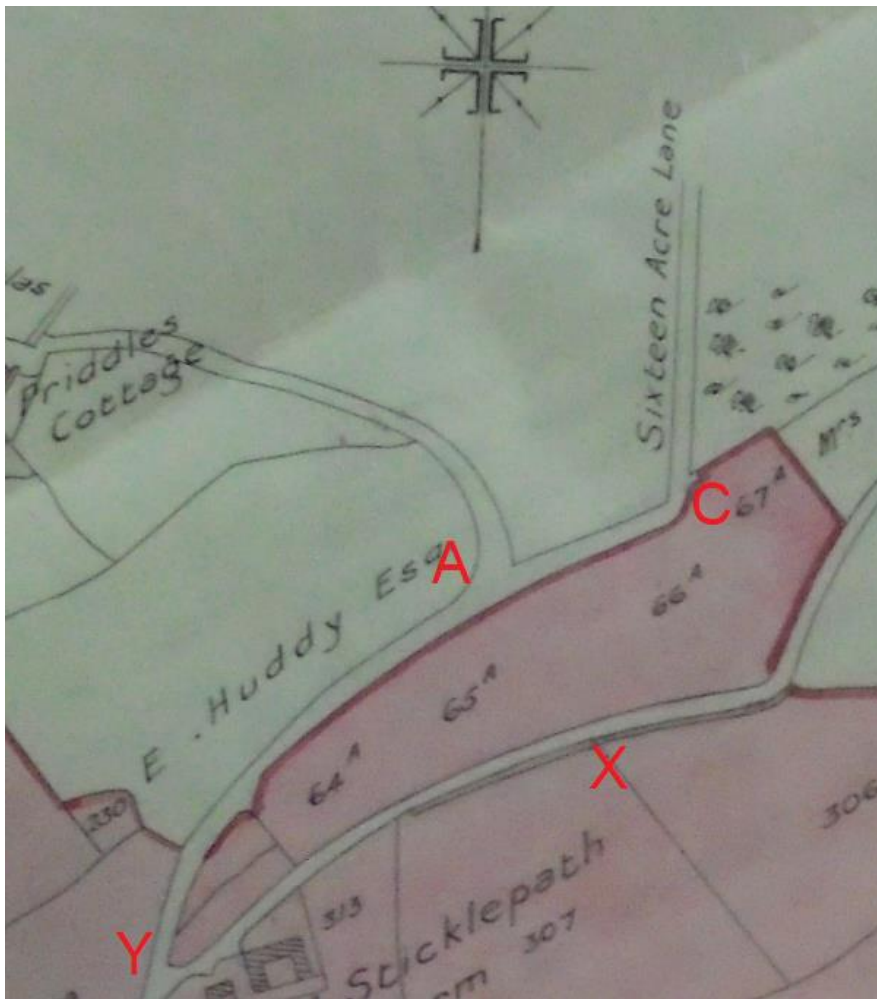

Detail showing the application route

NRS = No Recorded Status.

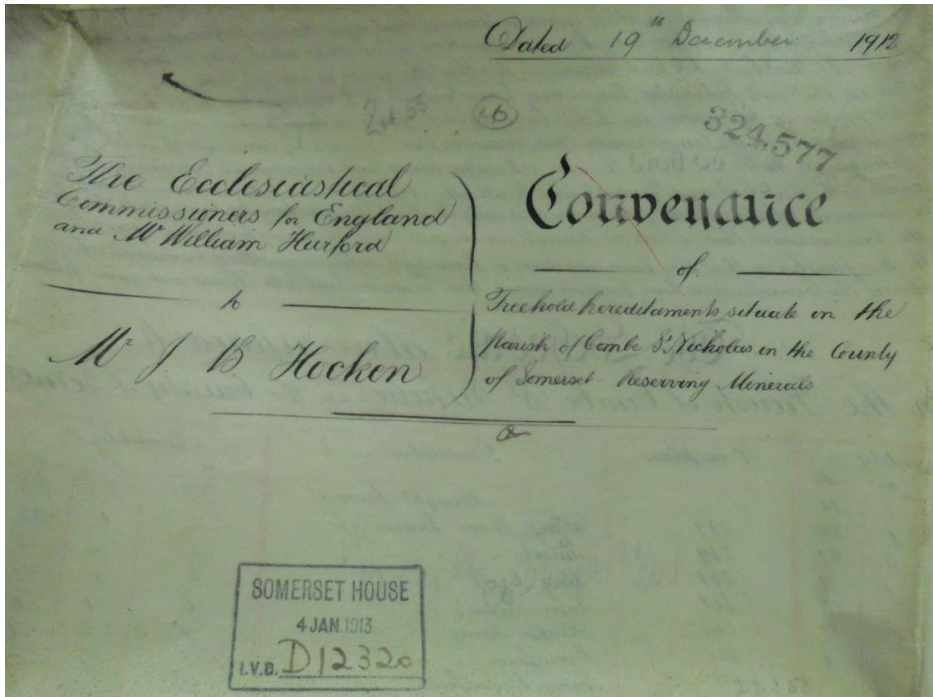
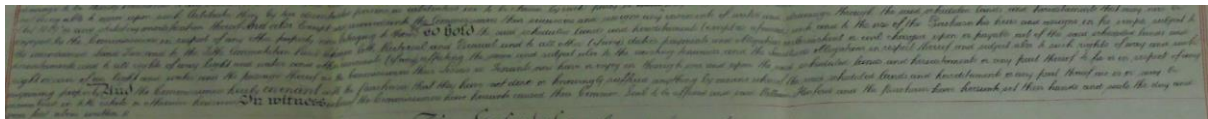

Transcript: "To hold the said scheduled lands and hereditaments (except as aforesaid) [unto?] and to the use of the Purchaser his heirs and assigns in fee simple subject to the [unredeemed] Land Tax and to the Tithe Commutation Rent Charge both Rectoral and Vicarial and to all other (if any) duties payments and obligations ecclesiastical or civil charges upon or payable out of the said scheduall rights of way light and water and other easements (if any) affecting the same and subject also to the existing tenancies and the [Landlords?] obligations in respect thereof and subject also to such rights of way and such [rights of use?] of [..] light and water and the passage thereof as the Commissioners their lessees or tenants now have or enjoy in through and upon the said scheduled lands and hereditaments or any part thereof to for or in respect of any [... ..]."