

Title Crickham - TM26.1

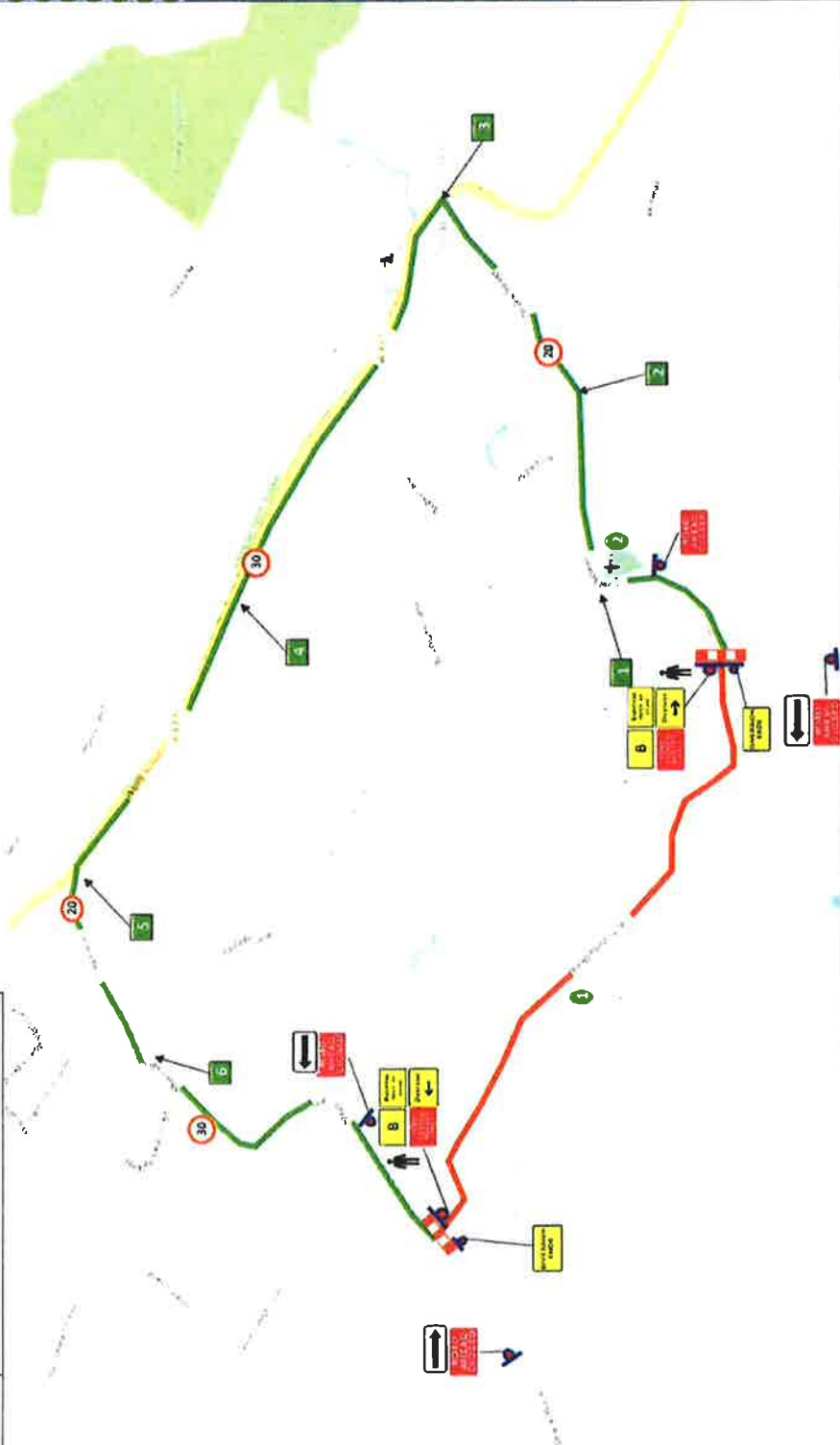

Businesses & Public Areas

1	Shop
2	S: Leonards Church
3	
4	
5	
6	
7	
8	

1	1	2	1	5	5	4	4	2	2
2	1	4	5	4	4	2	2	2	2
3	5	2	4	2	2	2	2	2	2
4	4	2	2	2	2	2	2	2	2
5	4	2	2	2	2	2	2	2	2
6	4	2	2	2	2	2	2	2	2
7	4	2	2	2	2	2	2	2	2
8	4	2	2	2	2	2	2	2	2

KEY

A	Access to residential frontages
B	Access to residential frontages and businesses
Person icon	Manned Closure
Red line	Proposed Closure
Green line	Proposed Diversion Route

Diversion Length	2.65	KM
Diversion Routes / Comments		
Stoke Street, Wells Road, Bay Lane, Moor Lane		
Drawing number	Crickham - TM26.1	
Date drawn	27/06/2018	
Drawn by	JD	
Approved by	GW	





First Call Traffic Management

Street	Honeyhurst Lane		
Town	Rodney Stoke		
USRN	25006963	Post Code	BS27 3UN
Address			
Start	Intersection with Barrow Wood Lane and Stoke Street		
End	Intersection with Moor Lane and Brook Bank		
Type of restriction requested	Road closure	Duration	Over 5 Days
Can pedestrian access through the site be maintained	YES		
Can access for cyclists and equestrians be maintained through the site?	YES		
Can emergency services gain access	YES		
Can public / school busses gain access through the site	NO		

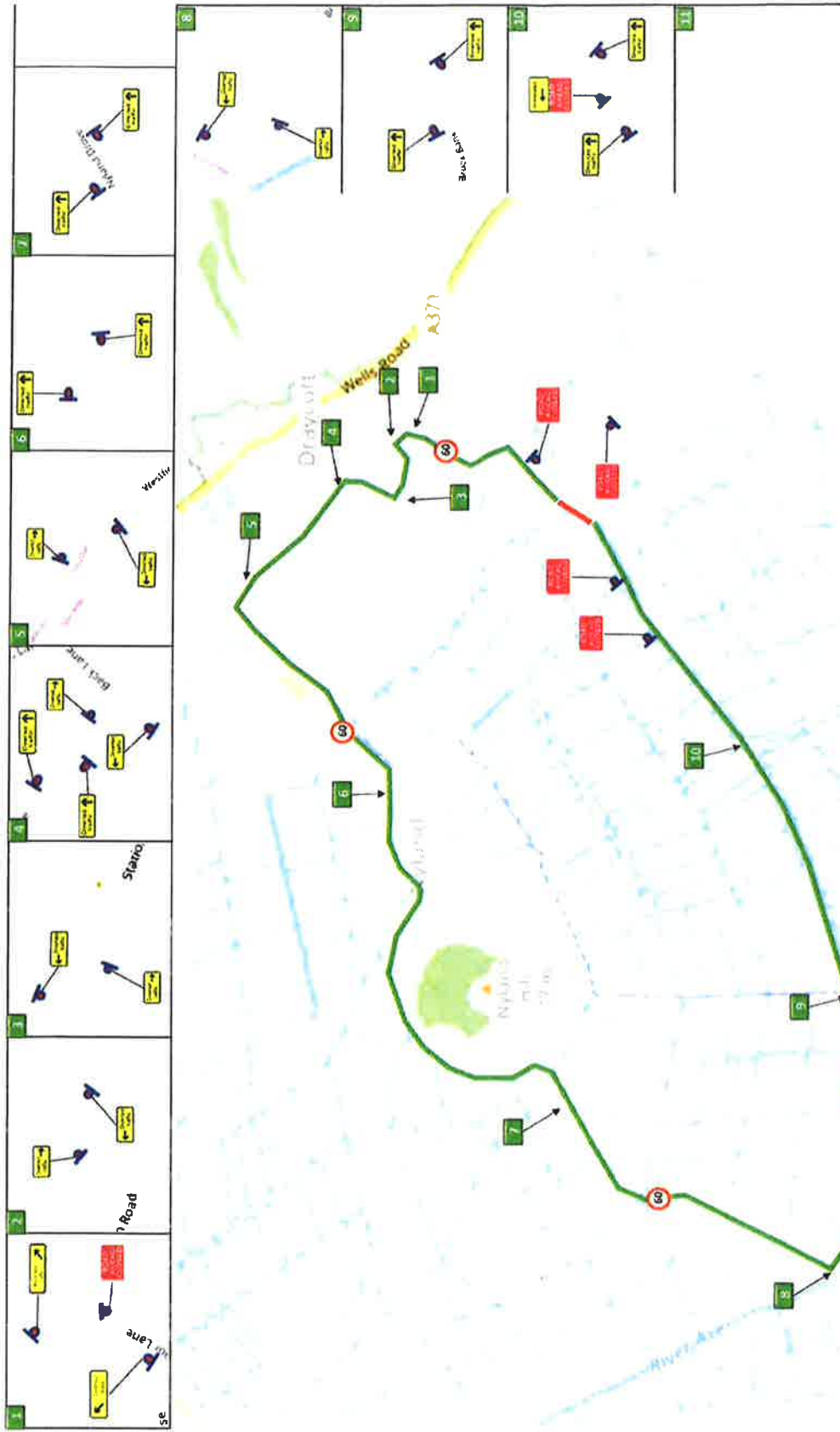

Drawing number	Crickham - TM41.1
Date drawn	07/11/2019
Drawn by	.JD
Approved by	GW

Title Rooksbridge - TM03.1

Businesses & Public Areas
Leather Seats Online

1	
2	
3	
4	
5	
6	
7	
8	

		4
		2
		4
		4
		4
		4

KEY

	Access to residential frontages
	Access to residential frontages and businesses
	Manned Closure
	Proposed Closure
	Proposed Diversion Route
Closure Length	175.00 Metres
Diversion Length	Km
Diversion Routes	

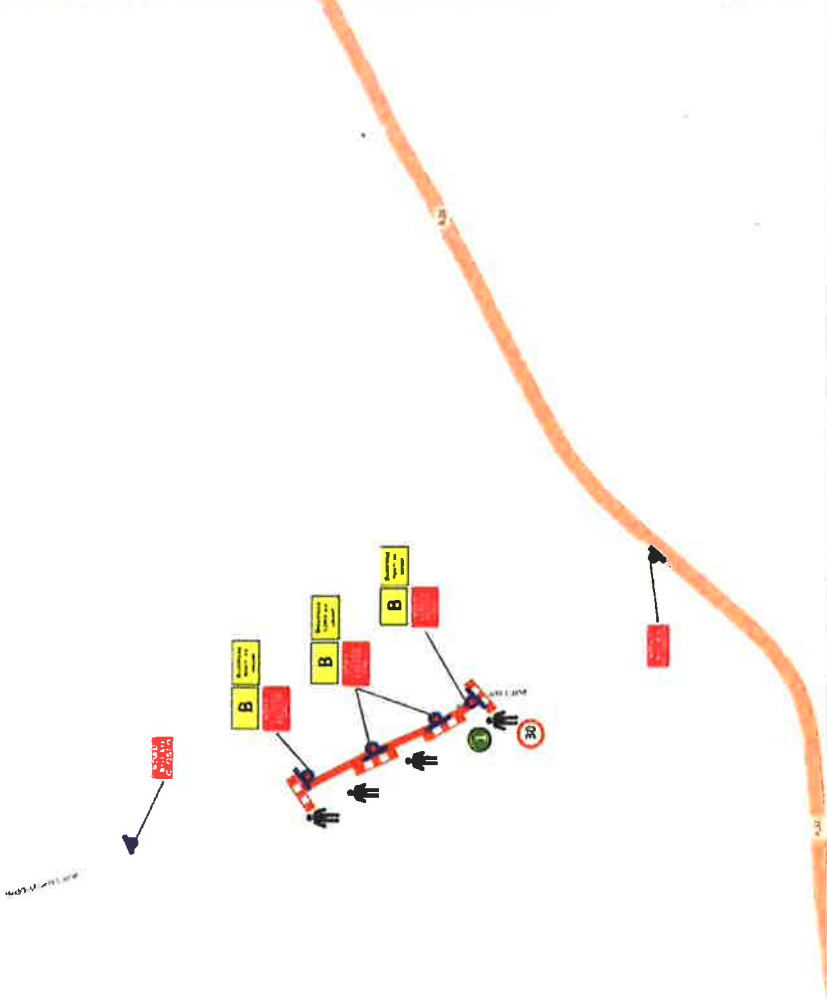

Street	Biddisham Lane
Town	Biddisham
USRN	34003395
Post Code	BS26 2RH
Address	
Co-ordinates	ST 38328 52972
Start	Junction of Blackthorn Lane
End	110 metres from junction of Blackthorn Lane
Type of restriction requested	Road closure
Duration	Over 5 Days
Can pedestrian access through the site be maintained	YES
Can access for cyclists and equestrians be maintained through the site?	YES
Can emergency services gain access	YES
Can public / school buses gain access through the site	NO





First Call Traffic Management

Access to be maintained where possible. (No through road)	
Drawing number	Rooksbridge - TM03.1
Date drawn	27/09/2019
Drawn by	JD
Approved by	GW