

- NET FINISHED**
- TEXT = PROPOSALS
 - PROPOSED SIGN POST LOCATION
 - PHOTOGRAPH LOCATION
 - SIGN REFERENCE NUMBER
 - LOCATION NUMBER
 - 4.3M LONG ROUNDELS (UNLESS OTHERWISE STATED)
 - NEW SLOW ROAD MARKING
 - 2.8M/1.6M HIGH WITH OR WITHOUT YELLOW TRANSVERSE BARS MARKINGS
 - VERGE MARKER POST, RED REFLECTOR FOR APPROACHING NEARSIDE TRAFFIC, INSTALL OUT OF VIZ PLAY (AT 18M CENTRES) UNLESS OTHERWISE SPECIFIED
 - RED UNIDIRECTIONAL REFLECTIVE EDGE STUDS 18M SPACINGS FOR NEARSIDE TRAFFIC (UNLESS OTHERWISE STATED)
 - RESTRICTED BY-WAY
 - RESTRICTED BY-WAY FOOTPATH
 - EXISTING CONDITIONS
 - EXISTING CARRIAGEWAY WIDTH
 - EXISTING ROADWAY WIDTH
 - EXISTING ELECTRICITY POLE
 - EXISTING PEDESTRIAN ACCESS
 - EXISTING VEHICULAR ACCESS
 - EXISTING SIGN POST LOCATION
 - EXISTING ILLUMINATED COLUMN
 - EXISTING SLOW ROAD MARKINGS
 - EXISTING ROUNDELS
 - EXISTING SLOW ROAD MARKINGS
 - VEGETATION CLEARANCE
 - NEW PINCH POINTS APPROX 30m LONG

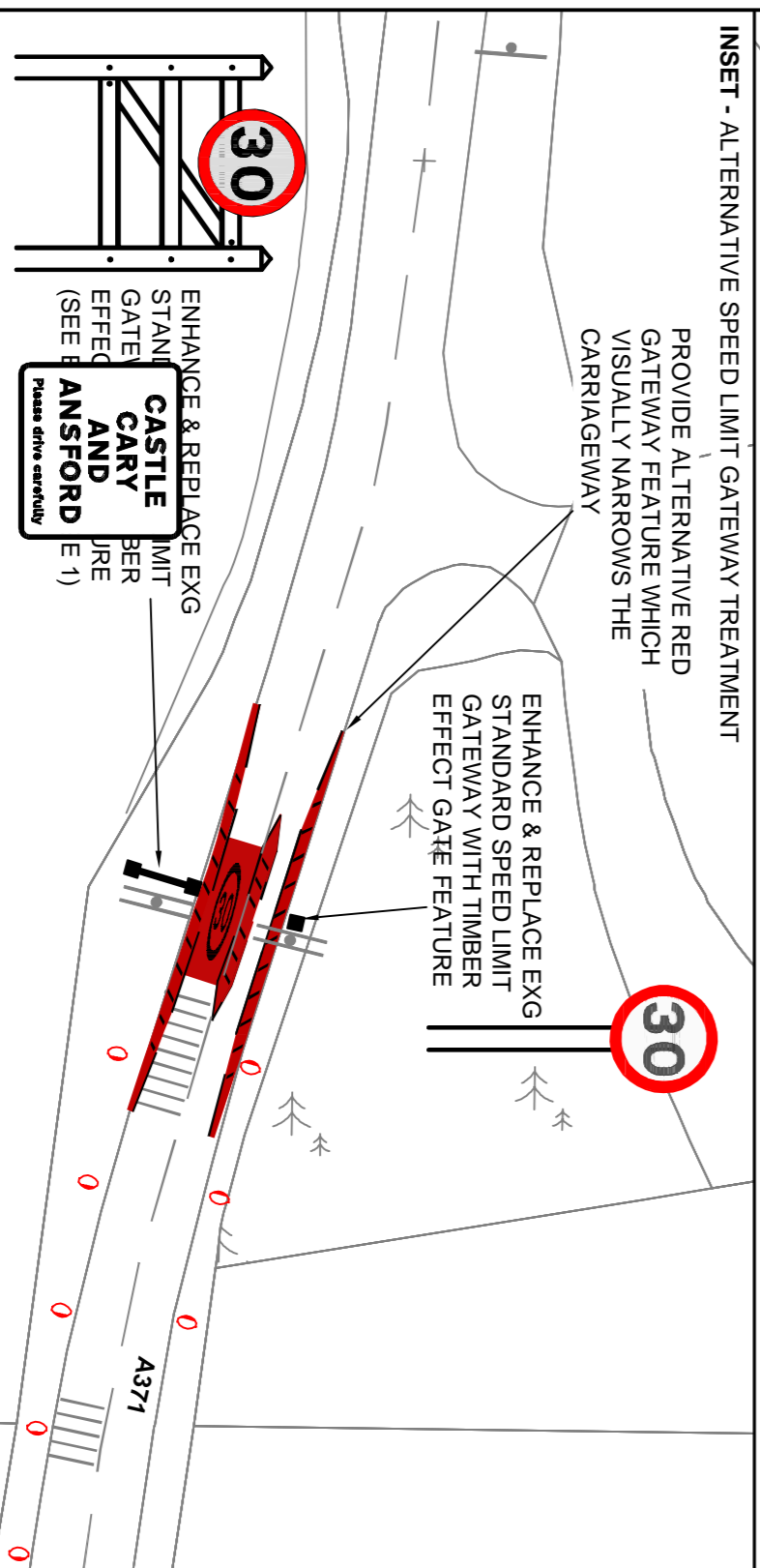
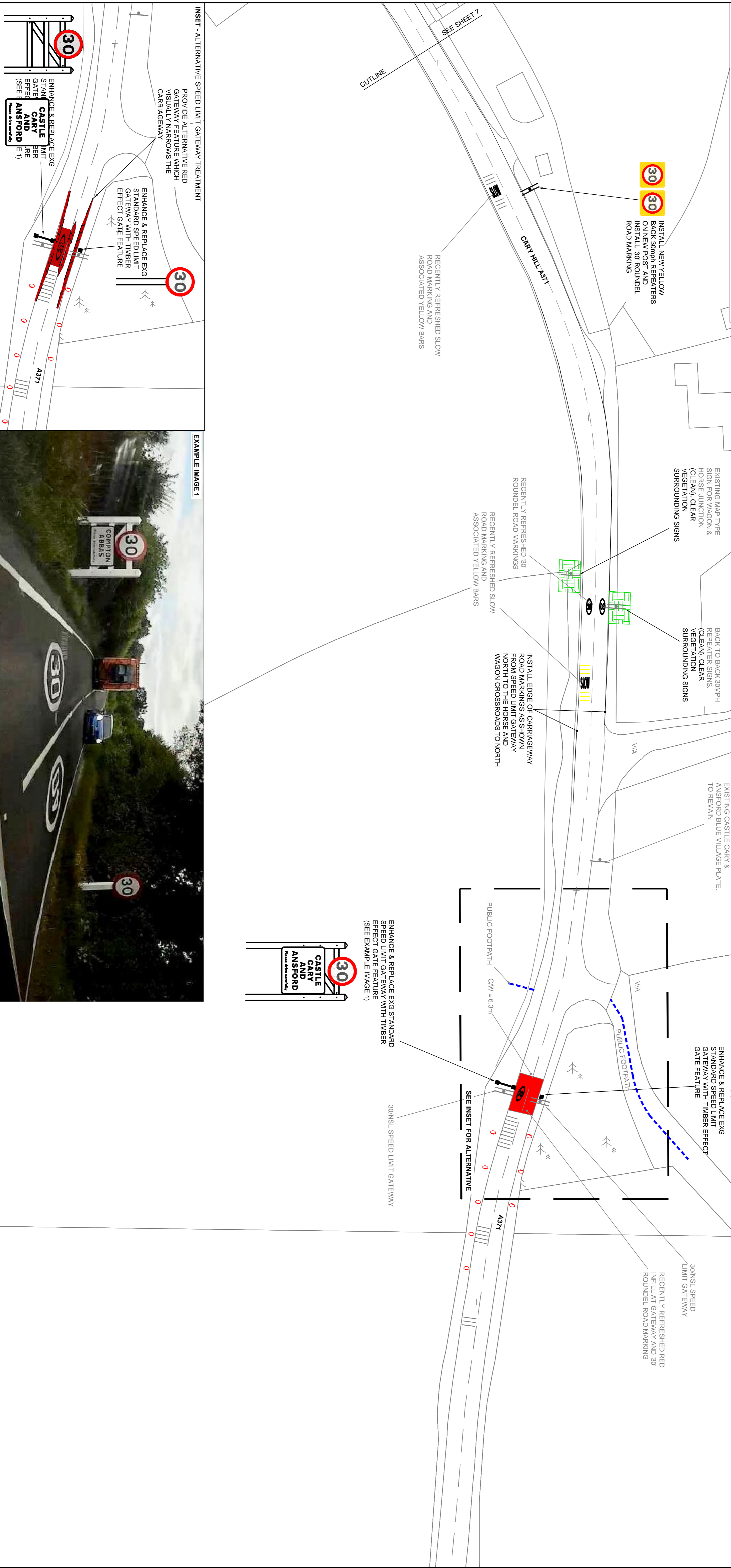

EXAMPLE IMAGE 1

Rev	Description	By	Date	Chk'd	App'd
-	FIRST ISSUE	JMP	12/18	JMP	SW
A	REVISION FOLLOWING CLIENT INSTRUCTIONS	JMP	10/19	RL	SW

© Crown Copyright and database right (2017). Ordnance Survey 100039392

0 10 100
Millimetres

SOMERSET COUNTY COUNCIL

Somerset County Council
Traffic & Transport Development Group

Exchange House
12-14 The Crescent
Taunton
TA1 4EB, UK
wsp.com

SOMERSET COUNTY COUNCIL
County Hall
Somerset
Taunton
TA1 4DY
TEL: (0300) 123 2224
www.somerset.gov.uk

Client: **SOMERSET COUNTY COUNCIL**

Title: **GENERAL ARRANGEMENT SHEET 8 OF 8**

Project: **CASTLE CARY TO ANSFORD RAILWAY BRIDGE SPEED REVIEW**

File Name: 70050596-018 Rev A (General Arrangement)

Original Scale	Scale	Date	Drawn	Checked	Authorised	Status
1:500	A1	08/18	JMP	RL	SW	F

Drawing Number: **70050596-018**

Rev: **A**